

# GREASE TRAP



## MACTRAP 500LP GREASE TRAP DATA SHEET

500L with pump out for above ground installation.

Sales code	Total volume (litres)	Treatment capacity (litres)	Length (mm)	Width (mm)	Height (mm)	Inlet invert	Pump Riser
MTPT500LP	700	460	1500	550	850	670	670

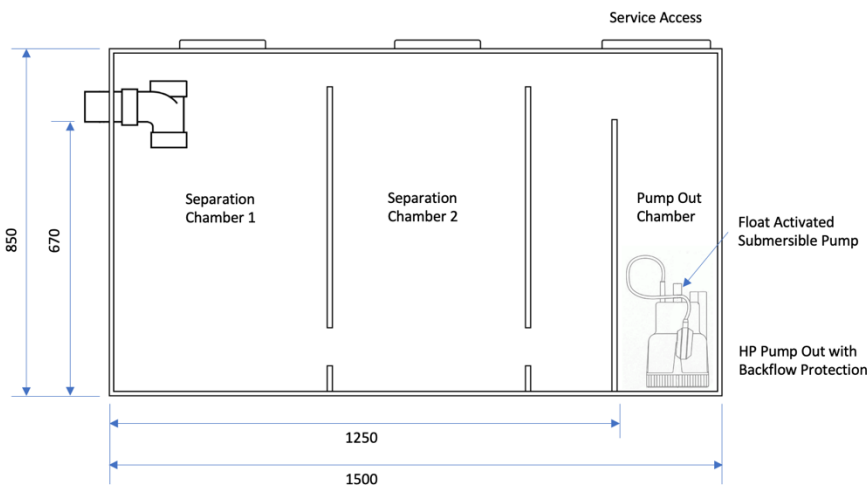
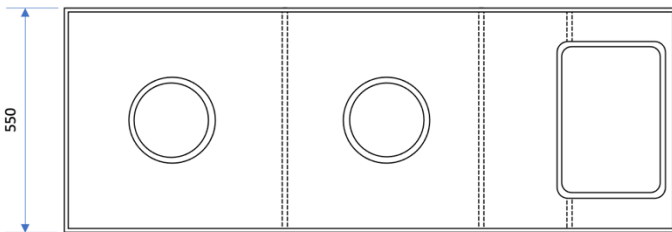

The diagrams show the 500L pipework for illustrative purposes.

Sink/pick up point should be above inlet height.

External inlet dimensions is 100mm (can be reduced to suit).

Less than 65°C continuous operating temperature.

Direct Combi oven connection requires a separate bulkhead fitting suitable for the Combi oven outlet.

A Combi oven inlet should be supplied with an in-line tundish.

The 500L must be vented at the inlet or at the top of the tank with a suitable bulkhead tank fitting.

### Lift Pump Technical Data

Power	Voltage	Current	Revolutions
P <sub>1</sub> =0.3 kW	230 V 50 Hz	1.6 A	2800 U/min
Weight	Cable	Continuous Temp	Short Term Temp
7.3 kg	4m	50°C	75°C

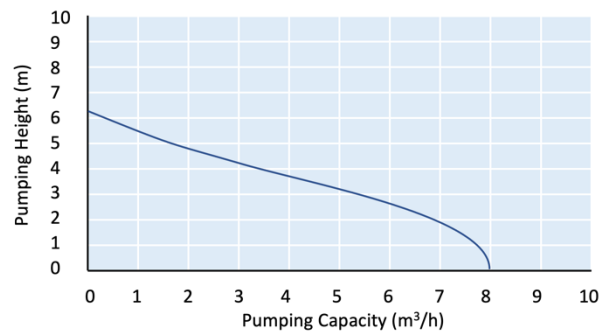

## INSTALLATION

### THE GREASE TRAP IS NOT LOAD BEARING

#### Location

Install the grease trap in a location that is accessible by manual or vacuum tanker so that it can be regularly cleaned out.

Locate the grease trap on a firm surface and brace it to a wall or alternative support to prevent it from moving or tipping.

Allow room above the grease trap for removal of the lids and access for the cleaning service.

If the grease trap will be exposed to direct sunlight in temperatures that can exceed 30°C then consider a shade structure.

If the grease trap will be exposed to temperatures below 0°C then consider a frost cover.

Ensure that the sink pickup point is above the inlet height.

If necessary, the grease trap can be partially buried so that the inlet invert is at the most appropriate height to suit the inlet plumbing.

- Cut the hole as close as possible to the size of the grease trap.
- Ensure the base is flat and firm with even compaction and at least 25mm of sand.
- Back fill the sides with sand and lightly compact.
- Leave the lids exposed for access and service.

#### Connections

Flexible couplings should be used for earthquake protection.

#### Lift Pump

The lift pump is pre-installed within the grease trap with the outlet on the specified side.

A locking set is fitted through the outer wall of the grease trap and connected to the lift pump with a quick release locking lever.

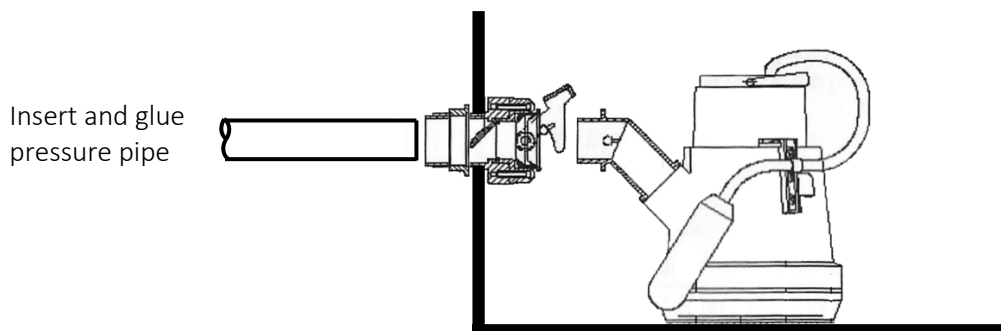

Insert and glue the outgoing pressure pipe (DN 40) inside the outlet portion of the lift pump connection. Make sure that the outgoing pressure pipe is securely installed.

Maximum head 5m.



## OPERATION

The Mactrap grease trap operates by allowing gravity to separate fats, oils, and grease (FOG) and sediments from discarded greasy water. A series of baffles slows the flow of water and reduces turbulence, allowing lighter than water FOG to float to the surface and heavier than water sediment to sink to the bottom. Cleaner wastewater flows into the pump chamber and is pumped to waste, while the FOG and sediment is retained within the grease trap.

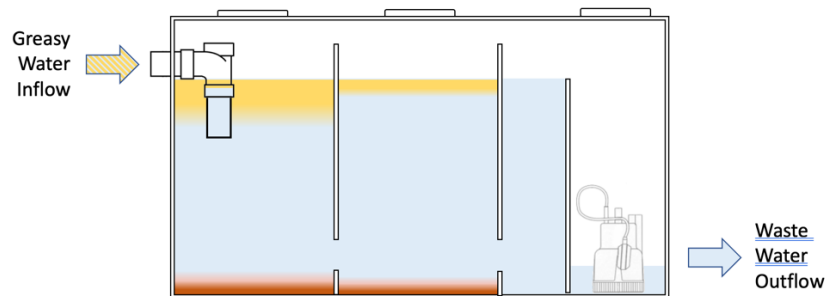

The very simple principle of operation works very efficiently. To ensure the continuing efficiency of the grease trap it must be periodically cleaned, and both the FOG and sediment removed. If the periodic cleaning is not carried out then the level of FOG increases to the point where separation fails and the wastewater outflow contains FOG, or the sediment levels increase to the point where the outflow is blocked.

## AFTER-INSTALLATION CARE AND SERVICING

Whilst this product is highly robust, care is required to ensure efficient operation.

### Water temperature

The grease trap is certified to operate with water temperatures up to 65°C. Continuous temperatures in excess of 65°C, without additional bracing, may cause sagging in the outer wall of the grease trap. Temperatures in excess of 75°C may cause damage to the lift pump and invalidate the warranty.

### Chemicals

The grease trap is tested to handle most kitchen factory type chemicals especially as they are usually diluted with water. Pure benzene and concentrated sulphuric acid should not be used.

### Sink Filters

Grease traps are not a rubbish bin, so the more solids that can be removed using sink filters, the higher the efficiency of the grease trap operation. FOG solidifying on the surface of the water is not usually the major source of distasteful odours. Food solids rotting as sediment is typically the source.

### Clean Out

The frequency of clean out is totally dependent on how much fat, oil and grease is intercepted. Under normal usage, Mactrap recommends at least two clean outs per year, however heavy use or excess solids may require more frequent clean outs. In normal circumstances grease traps are cleaned out by a vacuum truck. The entire contents are drained and removed before refilling the grease trap for continued operation.



Inadequate clean out will result in FOG progressing to the pump chamber and may cause blockage or damage to the lift pump.

## AVOID FOOD SOLIDS GETTING INTO THE GREASE TRAP

### Lift Pump Removal and Service

The lift pump may be removed for cleaning by releasing the locking lever and lifting the pump assembly to the top of the grease trap. Clean and service as required.

## ISOLATE THE POWER SUPPLY BEFORE DISMANTLING PUMP

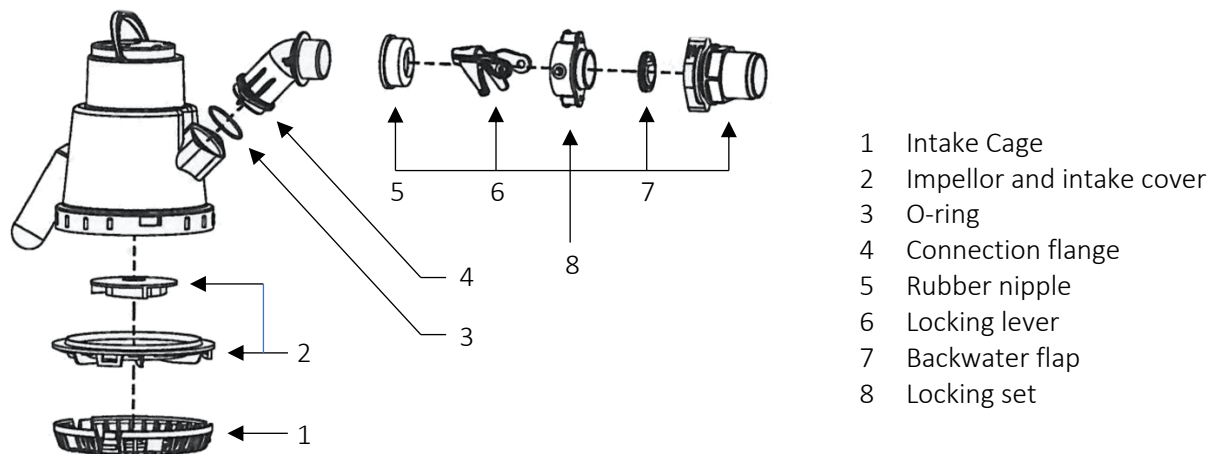

Complete removal of the lift pump will require the disconnection of the supply cable at the switched circuit box located on the side of the grease trap above the high-pressure outlet.

## WARRANTY

Mastrap polymer grease traps are manufactured from high molecular weight HDPE with minimum 12mm wall thickness. They have slot filleted baffles and walls to ensure perfect welding and virtually no loss of strength to the HDPE.

The Mastrap polymer grease trap plastic is warranted for impermeability, fitness for use and structural stability for 30 years if installed underground and for 10 years if installed above ground. The manufactured unit is warranted for quality of manufacture for 5 years provided installation and operation are as per these specifications provided with each unit. Mastrap expressly states that wear and tear is not a defect and the same applies to defects from defective servicing.

The lift pump carries a full replacement warranty for 12 months from date of installation.

