

# DENTAL

## MTDT25 - DENTAL TRAP DATASHEET

### UNDER BENCH INSTALLATION



Product code	MTDT25L	MTDT25H
Inlet (mm)	195	315
Outlet (mm)	160	140
Height (mm)	290	410
Width (mm)	380	380
Length (mm)	440	440
Capacity	27 l	n/a

#### Accessories

Quick Connects	MTUBQC
HDPE Rolling Trolley	MTERTP25

## OPERATION

MACTRAP Dental and Plaster Traps are small, filtered sediment traps specially designed to remove plaster and particulate matter from the wastewater before discharging to the network. A sealed lid contains odours and each unit is equipped with an easily removeable washable filter

They are easily installed and serviced and will handle most of the chemicals used in modern medicine, dentistry, and medical laboratories. Both compact dental/plaster models are easily fitted under-bench and have a clear lid that lifts for inspection and cleaning.

### Wet Filter (Low Profile)

The MACTRAP Wet Filter model captures coarse solids in the filter and finer particulate matter settles as sediment. The captured sediment will require periodic removal. The settlement model has a low profile and is suitable for confined spaces.

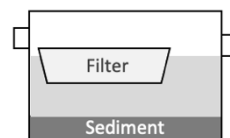

### Dry Filter (High Profile)

For environments without the need to capture fine particulates, MACTRAP has developed the Dry Filter model. The Dry Filter has legs to raise the unit, allowing the wastewater to self-drain and the filter basket to remain above the water level for easier, cleaner disposal of waste products.

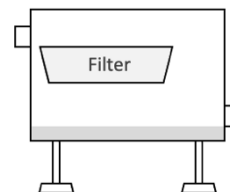



## WARRANTY

The Mactrap sediment trap is warranted for impermeability, fitness for use and structural stability for five (5) years. The manufactured unit is warranted for quality of manufacture for one (1) year provided the dental trap is installed and operated in accordance with the specifications provided with each unit. Mactrap warranty does not include maintenance and servicing of the sediment trap.

## INSTALLATION

1. Plumb direct to inlet or outlet using 50mm PVC pipe.
2. Ensure that the external drain is lower than inlet.
3. If the outlet is plumbed direct into sewage, then a P-trap or similar should be installed after the outlet.

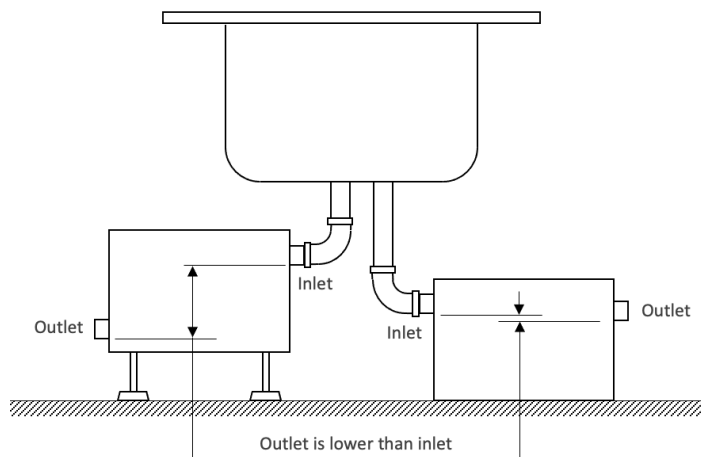

## CARE AND SERVICING

The Mactrap Plaster Trap is designed to allow plaster particles to be caught in the filter basket. These particles then form a sludge in the filter basket. We recommend you empty the filter when the filter bag is around 1/3 full to avoid blockage in the trap. You can see how thick the sludge is by lifting the lid and checking the sludge level in the filter. To clean the Mactrap Plaster Trap, lift the lid and remove the filter basket. Tip the contents into a rubbish container and wipe clean. The filter bag can be removed from the frame and washed.

## ACCESSORIES

### *MTUBQC – Quick Connects*

Quick connects simple disconnect the trap from your drainage so it can be removed for easy cleaning.

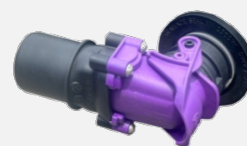

### *MTERTP25 – Rolling Trolley Low Profile*

The rolling trolley, in association with quick connects, makes servicing the trap a breeze. Especially in tight spaces. Release the quick connects to disconnect the trap from the plumbing and roll out from under the bench. Convenient handles make it easy to remove the trap for cleaning.

